

Extra Heavy Duty Steel Lintel

CX70/125

Steel lintel for use in extra heavy duty masonry cavity wall construction, designed to support typical masonry, timber floor and roof loads found in most buildings and suitable for fairfaced inner leaf masonry. Open back profile allows masonry to be built up continuously on both outer and inner leaf. Manufactured from galvanised steel, supplied fully insulated, with integral plaster key and Catnic's signature black powder coating

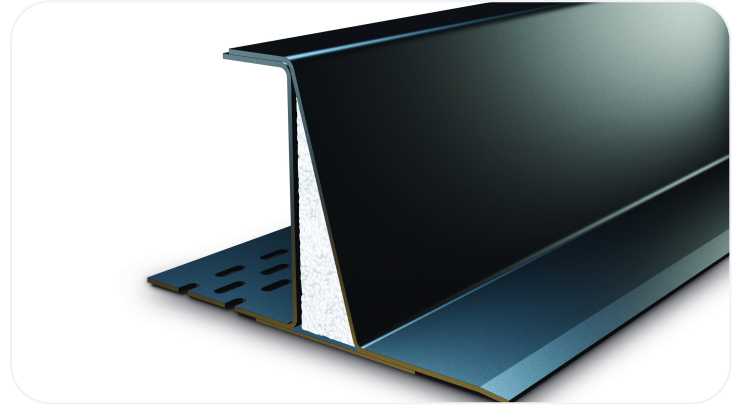

Wall Construction	CAVITY WALL
Inner Leaf	125-140
Outer Leaf	100-102
Cavity	70-85
Loading Conditions	EXTRA HEAVY DUTY

Specification

Product Code	Standard Length (mm)	SWL (kN) 1:1/19:1	Weight (kg)	Nominal Height (mm)
CX70/1250900	900	60	14.91	232
CX70/1251050	1050	60	17.40	232
CX70/1251200	1200	60	19.88	232
CX70/1251350	1350	60	22.37	232
CX70/1251500	1500	60	24.86	232
CX70/1251650	1650	60	27.34	232
CX70/1251800	1800	60	29.83	232
CX70/1251950	1950	60	32.31	232
CX70/1252100	2100	60	34.80	232
CX70/1252250	2250	60	37.28	232
CX70/1252400	2400	60	39.77	232
CX70/1252550	2550	60	42.25	232
CX70/1252700	2700	60	44.74	232
CX70/1252850	2850	55	47.22	232
CX70/1253000	3000	55	49.71	232
CX70/1253300	3300	50	67.82	232
CX70/1253600	3600	50	73.98	232
CX70/1253900	3900	50	80.15	232
CX70/1254200	4200	32	86.31	232
CX70/1254575	4575	32	94.02	232
CX70/1254800	4800	32	98.64	232

- The SWL (safe working load) is based on the total UDL (uniform distributed load) over maximum span using 150mm end bearings.

- Standard lengths are available in increments of 150mm at lengths up to 3000mm, 300mm at lengths from 3000mm - 4800mm (including 4575 but excluding 4500mm).
- When using the Catnic CH and CX Open Back ranges with concrete floors, always ensure that the blockwork is built tight against the inner vertical face, and that a mortar joint is added to the top of the blockwork so that the floor units have an even spread over the inner flange of the lintel.

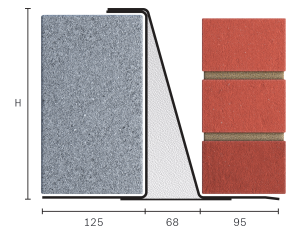

All ratios are shown inner to outer

Benefits

- Duplex Corrosion Protection
- Integral Plaster Key
- Built-In DPC
- Integral Insulation

- Made in the UK for a lower carbon footprint and certified to BES 6001 Responsible Sourcing standard.
- Made using lower carbon manufacturing
- It is possible to reuse all of our lintels, providing that they are not damaged. Contact our technical team for more information

Note: Whilst the above information is intended to offer general guidance regarding typical applications, it should not be considered as comprehensive. Requirements not fully covered by the above should be referred to our technical services department for individual consideration.

Catnic

Pontypandy Industrial Estate Caerphilly CF83 3GL
United Kingdom

+44 (0)29 2033 7900

catnic.technical@tatasteeleurope.com

catnic.com

Tata Steel UK Limited

18 Grosvenor Place, London, SW1X 7HS

Registered in England No. 02280000

Care has been taken to ensure that the contents of this publication are accurate, but Tata Steel Europe Limited and its subsidiaries, which includes Tata Steel UK Limited, do not accept responsibility or liability for errors or information that is found to be misleading. Before using products or services supplied or manufactured by Tata Steel Europe Limited and its subsidiaries, customers should satisfy themselves as to their suitability.

© Copyright 2026 Tata Steel UK Limited