

# Extra Heavy Duty Steel Lintel

## CX50/100

Wall Construction	CAVITY WALL
Inner Leaf	100-115
Outer Leaf	100-102
Cavity	50-65
Loading Conditions	EXTRA HEAVY DUTY

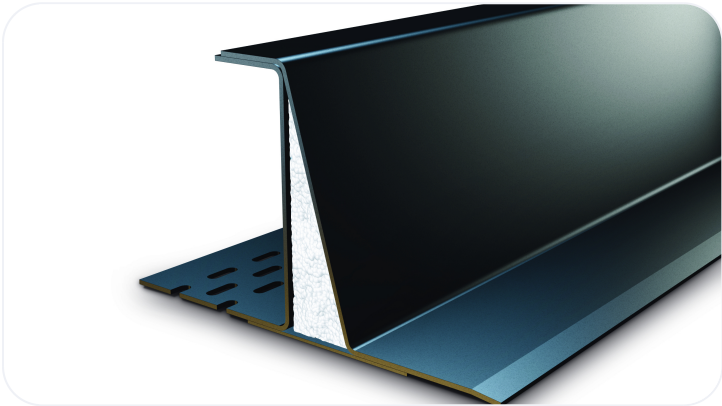

### Specification

Product Code	Standard Length (mm)	SWL (kN) 1:1/19:1	Weight (kg)	Nominal Height (mm)
CX50/1000900	900	60	14.36	232
CX50/1001050	1050	60	16.75	232
CX50/1001200	1200	60	19.14	232
CX50/1001350	1350	60	21.53	232
CX50/1001500	1500	60	23.93	232
CX50/1001650	1650	60	26.32	232
CX50/1001800	1800	60	28.71	232
CX50/1001950	1950	60	31.10	232
CX50/1002100	2100	60	33.50	232
CX50/1002250	2250	60	35.89	232
CX50/1002400	2400	60	38.28	232
CX50/1002550	2550	60	40.67	232
CX50/1002700	2700	60	43.07	232
CX50/1002850	2850	55	45.46	232
CX50/1003000	3000	55	47.85	232
CX50/1003300	3300	50	64.02	232
CX50/1003600	3600	50	69.84	232
CX50/1003900	3900	50	75.66	232
CX50/1004200	4200	32	81.48	232
CX50/1004575	4575	32	88.76	232
CX50/1004800	4800	32	93.12	232

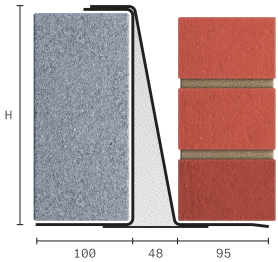

All ratios are shown inner to outer

- The SWL (safe working load) is based on the total UDL (uniform distributed load) over maximum span using 150mm end bearings.
- Standard lengths are available in increments of 150mm at lengths up to 3000mm, 300mm at lengths from 3000mm - 4800mm (including 4575 but excluding 4500mm).
- When using the Catnic CH and CX Open Back ranges with concrete floors, always ensure that the blockwork is built tight against the inner vertical face, and that a mortar joint is added to the top of the blockwork so that the floor units have an even spread over the inner flange of the lintel.

**Note:** Whilst the above information is intended to offer general guidance regarding typical applications, it should not be considered as comprehensive. Requirements not fully covered by the above should be referred to our technical services department for individual consideration.

#### **Catnic**

Pontypandy Industrial Estate Caerphilly CF83 3GL  
United Kingdom  
+44 (0)29 2033 7900

[catnic.technical@tatasteeleurope.com](mailto:catnic.technical@tatasteeleurope.com)

[catnic.com](https://catnic.com)

#### **Tata Steel UK Limited**

18 Grosvenor Place, London, SW1X 7HS  
Registered in England No. 02280000

Care has been taken to ensure that the contents of this publication are accurate, but Tata Steel Europe Limited and its subsidiaries, which includes Tata Steel UK Limited, do not accept responsibility or liability for errors or information that is found to be misleading. Before using products or services supplied or manufactured by Tata Steel Europe Limited and its subsidiaries, customers should satisfy themselves as to their suitability.

© Copyright 2025 Tata Steel UK Limited