

Heavy Duty Steel Lintel

CH130/125

Heavy duty steel lintel for use in cavity wall construction, designed to support typical masonry, timber floor, roof loads and suitable for fairfaced inner leaf masonry. Open back profile allows masonry to be built up continuously on both outer and inner leaf. Manufactured from galvanised steel, supplied fully insulated, with integral plaster key, and built in DPC thanks to Catnic's signature black powder coating.

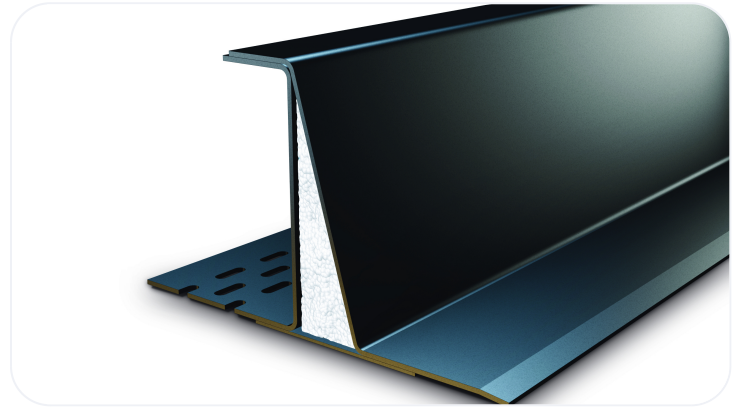

| | |
|---------------------------|-------------|
| Wall Construction | CAVITY WALL |
| Inner Leaf | 125-140 |
| Outer Leaf | 100-102 |
| Cavity | 130-145 |
| Loading Conditions | HEAVY DUTY |

Specification

| Product Code | Standard Length (mm) | SWL (kN) 1:1/19:1 | Weight (kg) | Nominal Height (mm) |
|---------------|----------------------|-------------------|-------------|---------------------|
| CH130/1252100 | 100 | 48 | 26.23 | 158 |
| CH130/1250900 | 900 | 32 | 11.24 | 158 |
| CH130/1251050 | 1050 | 32 | 13.11 | 158 |
| CH130/1251200 | 1200 | 32 | 14.99 | 158 |
| CH130/1251350 | 1350 | 32 | 16.86 | 158 |
| CH130/1251500 | 1500 | 32 | 18.73 | 158 |
| CH130/1251650 | 1650 | 32 | 20.60 | 158 |
| CH130/1251800 | 1800 | 32 | 22.48 | 158 |
| CH130/1251950 | 1950 | 48 | 24.35 | 158 |
| CH130/1252250 | 2250 | 45 | 28.10 | 158 |
| CH130/1252400 | 2400 | 45 | 29.97 | 158 |

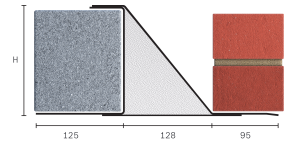

All ratios are shown inner to outer

- The SWL (safe working load) is based on the total UDL (uniform distributed load) over maximum span using 150mm end bearings.
- Standard lengths are available in 150mm increments up to 2400mm.
- When using the Catnic CH and CX Open Back ranges with concrete floors, always ensure that the blockwork is built tight against the inner vertical face, and that a mortar joint is added to the top of the blockwork so that the floor units have an even spread over the inner flange of the lintel.

Benefits

- Duplex Corrosion Protection
- Integral Plaster Key
- Built-In DPC
- Integral Insulation

- Made in the UK for a lower carbon footprint and certified to BES 6001 Responsible Sourcing standard.
- Made using lower carbon manufacturing
- It is possible to reuse all of our lintels, providing that they are not damaged. Contact our technical team for more information

Note: Whilst the above information is intended to offer general guidance regarding typical applications, it should not be considered as comprehensive. Requirements not fully covered by the above should be referred to our technical services department for individual consideration.

Catnic

Pontypandy Industrial Estate Caerphilly CF83 3GL
United Kingdom
+44 (0)29 2033 7900

catnic.technical@tatasteeleurope.com

catnic.com

Tata Steel UK Limited

18 Grosvenor Place, London, SW1X 7HS
Registered in England No. 02280000

Care has been taken to ensure that the contents of this publication are accurate, but Tata Steel Europe Limited and its subsidiaries, which includes Tata Steel UK Limited, do not accept responsibility or liability for errors or information that is found to be misleading. Before using products or services supplied or manufactured by Tata Steel Europe Limited and its subsidiaries, customers should satisfy themselves as to their suitability.

© Copyright 2026 Tata Steel UK Limited