

# Extra Heavy Duty Steel Lintel

## BXD100

Wall Construction	INTERNAL WALL
Inner Leaf	100
Outer Leaf	N/A
Cavity	N/A
Loading Conditions	EXTRA HEAVY DUTY



### Specification

Product Code	Standard Length (mm)	SWL (kN)	Weight (kg)	Nominal Height (mm)
BXD1000750	750	47	7.05	143
BXD1000900	900	47	8.46	143
BXD1001050	1050	47	9.87	143
BXD1001200	1200	47	11.28	143
BXD1001350	1350	47	12.69	143
BXD1001500	1500	47	14.10	143
BXD1001650	1650	59	25.91	219
BXD1001800	1800	59	28.26	219
BXD1001950	1950	59	30.62	219
BXD1002100	2100	59	32.97	219
BXD1002250	2250	59	35.33	219
BXD1002400	2400	59	37.68	219
BXD1002550	2550	59	40.04	219
BXD1002700	2700	59	42.39	219

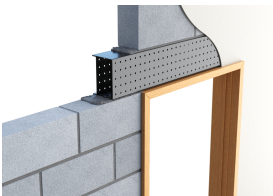

- The SWL (safe working load) is based on the total UDL (uniform distributed load) over maximum span using 150mm end bearings.
- Standard lengths are available in increments of 150mm at lengths up to 3000mm, 300mm at lengths from 3000mm to 4800mm (including 4575mm, but excluding 4500mm).

**Note:** Whilst the above information is intended to offer general guidance regarding typical applications, it should not be considered as comprehensive. Requirements not fully covered by the above should be referred to our technical services department for individual consideration.

**Catnic**  
Pontypandy Industrial Estate Caerphilly CF83 3GL  
United Kingdom  
+44 (0)29 2033 7900  
[catnic.technical@tatasteeleurope.com](mailto:catnic.technical@tatasteeleurope.com)  
[catnic.com](http://catnic.com)

**Tata Steel UK Limited**  
18 Grosvenor Place, London, SW1X 7HS  
Registered in England No. 02280000

Care has been taken to ensure that the contents of this publication are accurate, but Tata Steel Europe Limited and its subsidiaries, which includes Tata Steel UK Limited, do not accept responsibility or liability for errors or information that is found to be misleading. Before using products or services supplied or manufactured by Tata Steel Europe Limited and its subsidiaries, customers should satisfy themselves as to their suitability.